

Torque Angle Testers

MODEL-5125VC/VCW (Wide range)

Capacity: 5N · m (0.5Kgf · m)
Torque-Angle

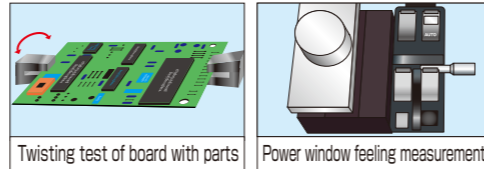

These are designed for complicated evaluation tests of various electronic, mechanical and other parts, including the torque angle tests, sliding torque tests, repetitive reducing torque measurement and so forth. The table in lower position rotates. The span from the work is adjusted with the torque meter mount in upper position, which is moved up and down manually. Select the proper torque meter and jig of the torque suitable to measurement. Test data and test waveform are displayed on the screen. In repetitive tests, waveforms are overwritten and displayed on the screen. Data are stored in the amplifier and printed.

Standard Specifications

Model	5125VC	5125VCW (Wide range)
Max. output torque	5N · m (0.5Kgf · m)	
Test speed	0.2 to 6RPM	0.1 to 20RPM
Speed changing	In five steps or continuous	
Angle setting	0 to 340° or continuous	
Displacement display	Provided	
Detector	Rotary encoder	
Display resolution	0.1 degree	
Display accuracy	1 degree	
Z-axis stroke	210 mm	
Distance between rotational center & column	110 mm	
Table size	150 mm dia.	
Driving mechanism	Ball speed reducer	
Drive motor	DC brushless	Servo motor
Weight	Approx. 55Kg	
Size	W350 x H767 x D475 mm	
Power supply	100 to 240VAC, single-phase, 0.5A	100 to 240VAC, single-phase, 5A

MODEL-5125VCT

Capacity: 5N · m (0.5Kgf · cm)
Torque-Angle

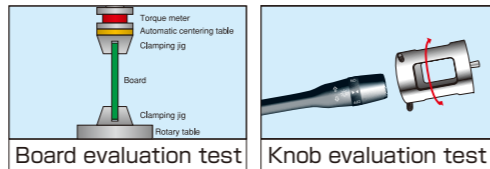

The MODEL-5125VCT designed for complicated evaluation tests of various electronic, mechanical and other parts, including the torque angle tests, sliding torque tests, repetitive reducing torque measurement and so forth. Various test conditions may be set on a touch panel. The table in lower position rotates. The span from the work is adjusted with the torque meter mount in upper position, which is moved up and down manually. Select the proper torque meter and jig of the torque suitable to measurement. Test data and test waveform are displayed on the screen. In repetitive tests, waveforms are overwritten and displayed on the screen. Data are stored in the amplifier and printed.

Standard Specifications

Max. output torque	5N · m (0.5Kgf · cm)	Z-axis stroke	210 mm
Test speed	0.1 to 20RPM	Distance between rotational center & column	110 mm
Speed changing	Free setting	Table size	150 mm dia.
Angle setting	0 to 340° or continuous	Driving mechanism	Ball speed reducer
Displacement display	Provided	Drive motor	Servo motor
Detector	Rotary encoder	Weight	Approx. 55Kg
Display resolution	0.1 degree	Size	W350 x H767 x D475mm
Display accuracy	1 degree	Power supply	100VAC, single-phase, 3A

Torque Angle Testers

MODEL-5401VC-50/200

Capacity: 5N · m/20N · m
(0.5Kgf · m/2Kgf · m)
Torque-Angle

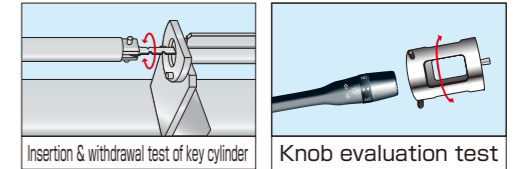

The MODEL-5401VC-50 and MODEL-5401VC-200 are capable of torque angle measurement up to 340degrees. Samples are fixed in the lower positions, and the torque meter in the upper positions rotate. The optional X-Y tables or jigs are installed on the sample measuring side. Attaching the automatic centering table to the torque meter enables smooth adjustment of the torque meter center to the work center. This function is convenient for samples that may not be rotated.

Standard Specifications

Model	5401VC-50	5401VC-200
Max. output torque	5N · m (0.5Kgf · m)	20N · m (2Kgf · m)
Test speed	0.2 to 1RPM	
Angle setting	0 to 340 degree	
Displacement display	Provided	
Detector	Rotary encoder	
Display resolution	0.1 degree	
Display accuracy	1 degree	
Z-axis stroke	140 mm	
Distance between rotational center & column	120 mm	
Table size	W350 x D320 mm	
Driving mechanism	Pully transmission mechanism	
Drive motor	DC brushless motor	
Weight	Approx. 60Kg	
Size	W490 x H742 x D480 mm	
Power supply	100VAC, single-phase, 0.5A	100VAC, single-phase, 1A

Large Size Torque Testers

MODEL-5127VC/500-5000

Capacity: 50N · m to 500N · m
(500kgf · cm to 5000Kgf · cm)
Torque-Angle



The MODEL-5127VC Series are designed to measure correlation of the torque angles of large automobile parts, electronic parts and so forth. Jigs or chucks are set on rotary tables in lower positions. Spans from works are adjusted with the cross head in upper positions, which are moved up and down by motors. Torque meters is fixed to the cross head. The MODEL-5127VC Series employ the MODEL-1016C amplifier for versatile evaluation tests of parts, including general torque breaking tests, repetitive durability evaluation tests and so forth.

Standard Specifications

Model	5127VC/500	5127VC/2000	5127VC/5000
Max. output torque	500Kgf · cm	2000Kgf · cm	5000Kgf · cm
Torque display	±500.0Kgf · cm	±2000Kgf · cm	±5000Kgf · cm
Load table rotation speed	0.05 to 2RPM		
Rotation accuracy	±0.5%		
Rotational angle display & setting	±0 to 10000.0 degree		
Table size	200 mm dia.	250 mm dia.	
Detector	Rotary encoder		
Motor	Servo motor		
Weight	Approx.350Kg	Approx.400Kg	Approx.700Kg
Size	W900 x H2300 x D600 mm		
Power supply	200VAC, three-phase		